



# Benner-Nawman, Inc.



3450 Sabin Brown Road • Wickenburg, AZ 85390 • (800) 992-3833 • Fax: (928) 684-7041 • mail@bnproducts.com

## HAS-Type Concrete Anchors



### HAS-TYPE WELD ANCHOR

This weld type anchor has an external bottom bearing expansion plug. It is designed to be hammered in and then attached to equipment by direct welding.

- This is a simple anchor system that leaves a weld stud exposed for use.
- Drill a hole and insert the anchor and hammer into place
- This anchoring method is ideal for installation of window, shutter and door framework.

HAS-Type Anchor

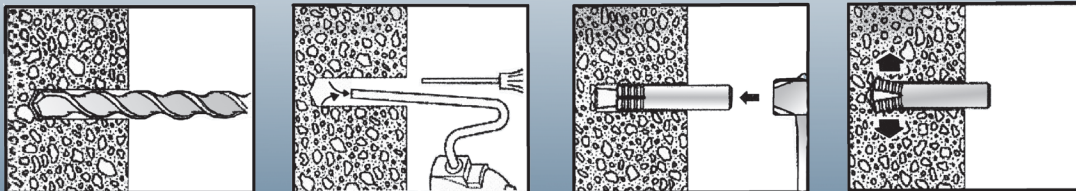

Product Code	Body Size	Drill Bit Diameter	Embedment Depth	Tension Load (lbs.)		Packing	
				Initial	Ultimate	Carton Qty.	Pallet Qty.
HAS-1055	3/8 x 2-3/16"	3/8"	1-9/16"	2,756	1,653	600	12,000